

PRE-REQUISITES

- Injury may occur if Gate & Key Switch is installed in the pathway of the motorized door or gate
- A minimum of 1 1/8" depth is required behind mounting surface
- Mechanical and eLock key switches are packaged in the locked/closed position

INSTALLATION INSTRUCTIONS

1. Wire the Gate & Key Switch to the gate controller.

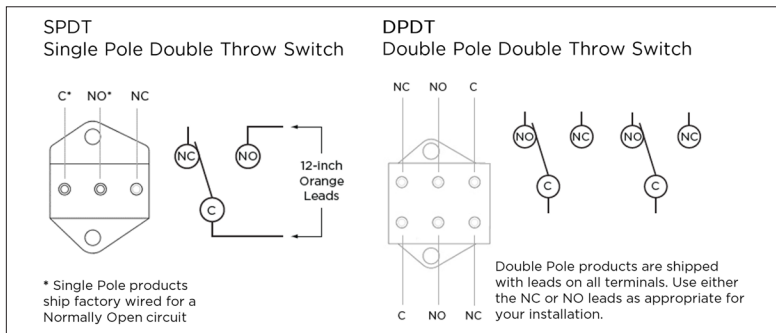

SPECIFICATIONS

Contacts are rated for a max of:

- 7A @125/250 VAC resistive
- 7A resistive/4A inductive at 28 VDC
- Contact leads: 20AWG Standard

- On the gate controller, wire NO lead to the Open Hold or Open on the Gate Controller.
- Wire switch Common to Common input on the Gate Controller.
- Use wire connectors appropriate for the installation conditions. Weather-resistant butt splice connectors are recommended.

2. Place gasket between the mounting surface and back of faceplate and align holes with faceplate holes.

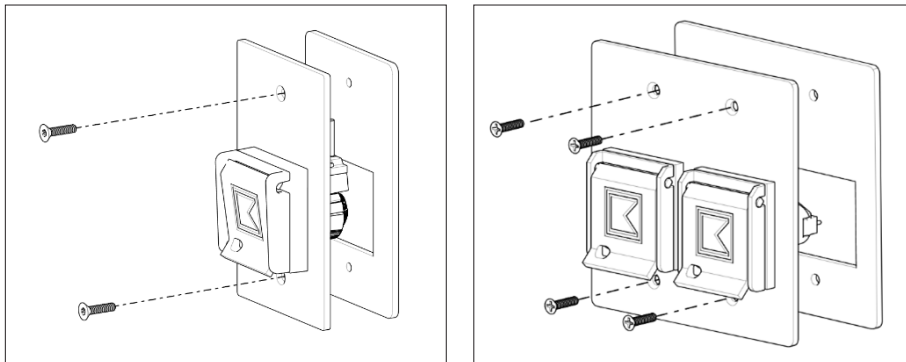

3. Using the provided Torx screws, fasten the faceplate assembly to the electrical box or existing panel.
4. Installation is complete. Confirm lock core is in the normal position as shown below. Contact your Fire Department for verification of operation. Knox eLock requires programming for your fire department for use.

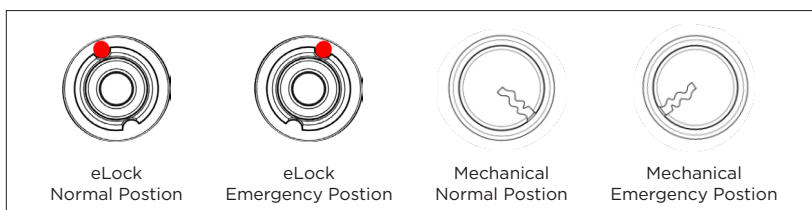

Using SPDT with a Normally Closed Circuit: The product can be converted to NC by soldering a 20 AWG stranded wire onto the NC terminal. Use a soldering iron of 1/8" diameter thermostatically controlled tip set to 500°F and resin core of 60% tin/40% lead solder. Do not touch the iron to the terminal for longer than 10 seconds. Excessive heat and flux will damage the switch. Do not dip or brush the terminals when cleaning as excess flux may damage the switch.

If you have questions regarding Knox Gate & Key Switch wiring, contact **Knox Tech Support** at **800-704-0889**

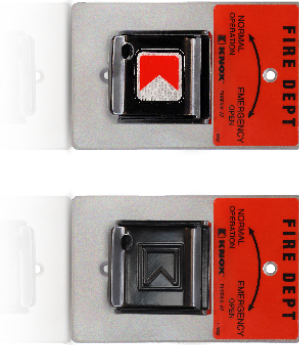

Visit
www.knoxbox.com
for more
information about
Knox Gate & Key
Switch Products



KNOX GATE & KEY SWITCH® INSTALLATION GUIDE

Need more security for your switch? Check out the Knox line of protective boxes.



Ensure rapid access through automated gates and other motor-operated barriers using Knox Gate & Key Switch®. This document provides instructions for installing Knox Gate and Key Switches with a single or dual faceplate.

PACKAGE CONTENTS

- (1) or (2) Key Switch Assembly
- (1) Gasket
- (2) or (4) Torx, Flat Head Screws, 6-32 X 5/8"
- Installation Instructions

TOOLS AND SUPPLIES

- Single or Double Gang Electrical Box
- T15 Torx Screwdriver

NOTE: Diagrams not shown to scale. KLS models are indicated by the red Knox "K" affixed to the dust cover.

SINGLE PLATE WITH GASKET (Models 3502, 3513, KLS-3502, KLS-3513)

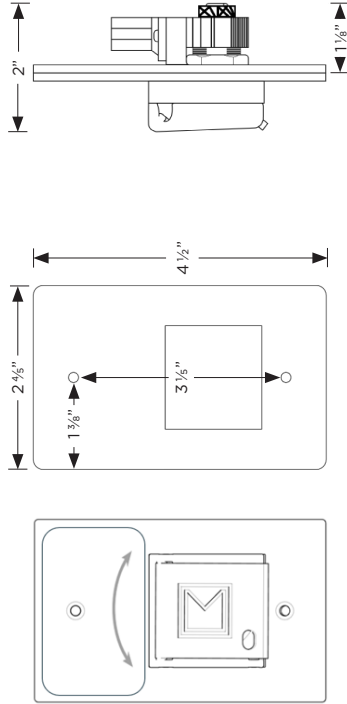

DOUBLE PLATE WITH GASKET (Models 3503, 3527, KLS-3503M, KLS-3527M)

