

This electric switch may be connected to most electric doors including those equipped with Maglock-type locks. Gates and other electrical equipment may also be operated by this switch.

Typically, the switch will be used to unlock electrical doors and gates that are controlled by a low voltage circuit. Other devices may require an intermediate control relay for use with higher voltages.

**The maximum load for this electrical switch is:
28 Volts AC/DC 5a**

This switch may be retrofitted into all KnoxBox 3200 boxes sold since April 2002 and KnoxVault 4400 vaults sold since January 2003.

Mounting Configurations

ALL BACKPLATES SHOWN WITHOUT HOUSING FOR CLARITY.

KnoxBox 3200 Hinged Door Model

Switch and Key Hook Brackets Share the Same Mounting Holes

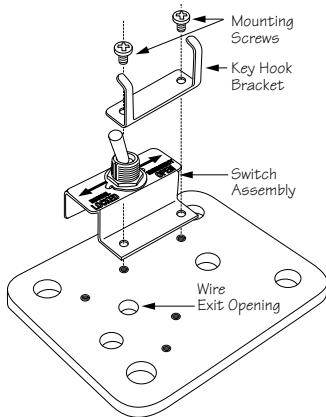

KnoxVault 4400

Switch Assembly **REPLACES** Right Key Hook Bracket - No Shared Holes

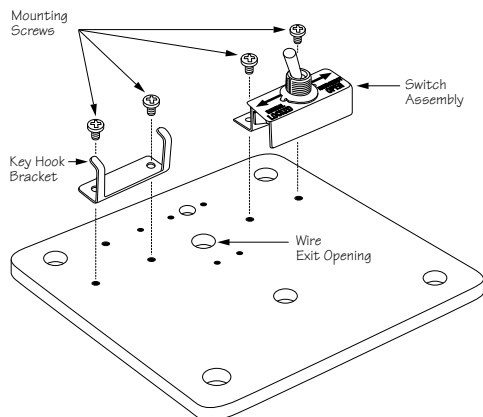

Mounting Bracket Orientation – KnoxBox 3200 vs. KnoxVault 4400

Please note that the switch and label orientation remain the same, only the bracket is reversed to accommodate mounting differences. The switch can be rotated when installed to allow for normally open or normally closed circuits.

KnoxBox 3200 Bracket Orientation

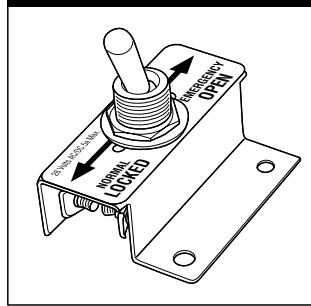

KnoxVault 4400 Bracket Orientation

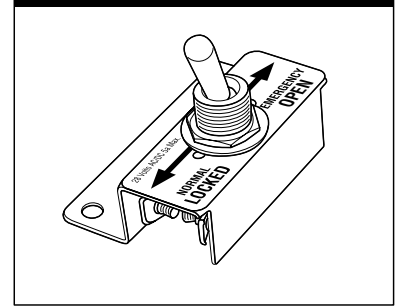

Normally Opened vs. Normally Closed Switch Operation

Switch units may be oriented to achieve either a normally opened or normally closed use. Upon installation, the switch must be inserted into its mounting hole so that the switch label will read correctly and the switch circuit will operate correctly when in use.

Normally CLOSED Circuit

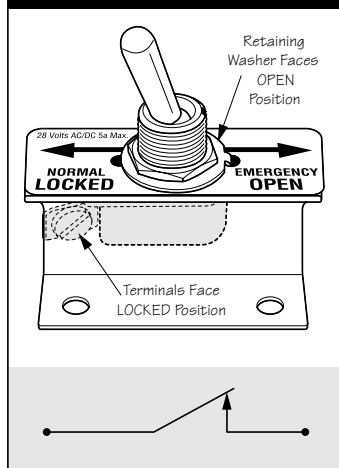

Normally OPEN Circuit

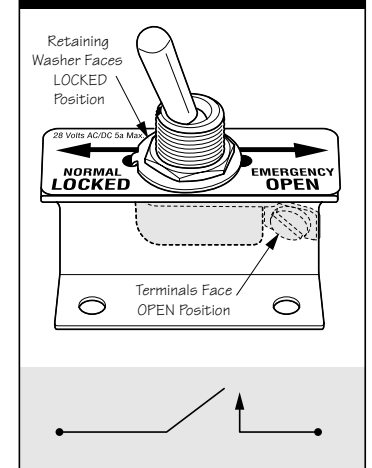

KnoxBVault 4400 Model

With Optional Knox Tamper Alert and Electrical Switch Installed

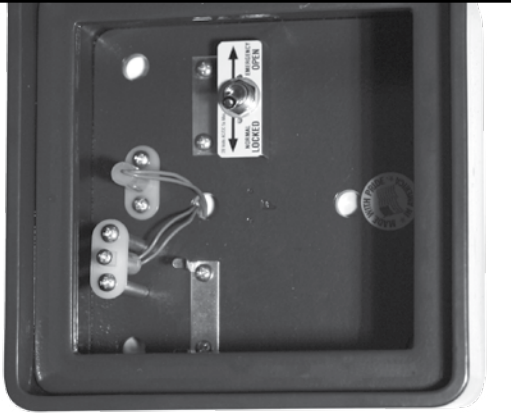

KnoxBox 3200 Hinged Model

With Optional Knox Tamper Alert and Electrical Switch Installed

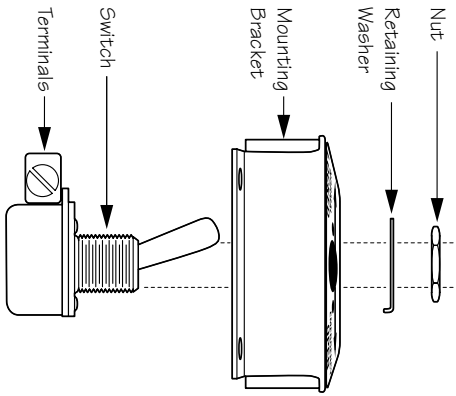

Switch Assembly

ELECTRICAL SWITCH

ELECTRICAL SWITCH INSTALLATION INSTRUCTIONS

For KnoxBox™ 3200 and KnoxBVault™ 4400

Issue Date: December 2017



1601 W. Deer Valley Road
Phoenix, AZ 85027
800-552-5669 • Fax 623-687-2290
info@knoxbox.com
www.knoxbox.com

OPE-MTGNS-0107-B

The maximum load for this electrical switch is:
28 Volts AC/DC 5a

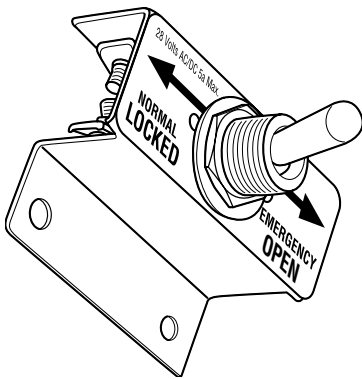

Optional electric switch for use in all KnoxBox 3200 boxes and KnoxBVault 4400 vaults.

ELECTRICAL SWITCH

ELECTRICAL SWITCH INSTALLATION INSTRUCTIONS

For KnoxBox™ 3200 and KnoxBVault™ 4400

Issue Date: December 2017



1601 W. Deer Valley Road
Phoenix, AZ 85027
800-552-5669 • Fax 623-687-2290
info@knoxbox.com
www.knoxbox.com